

1 Axonometric Section

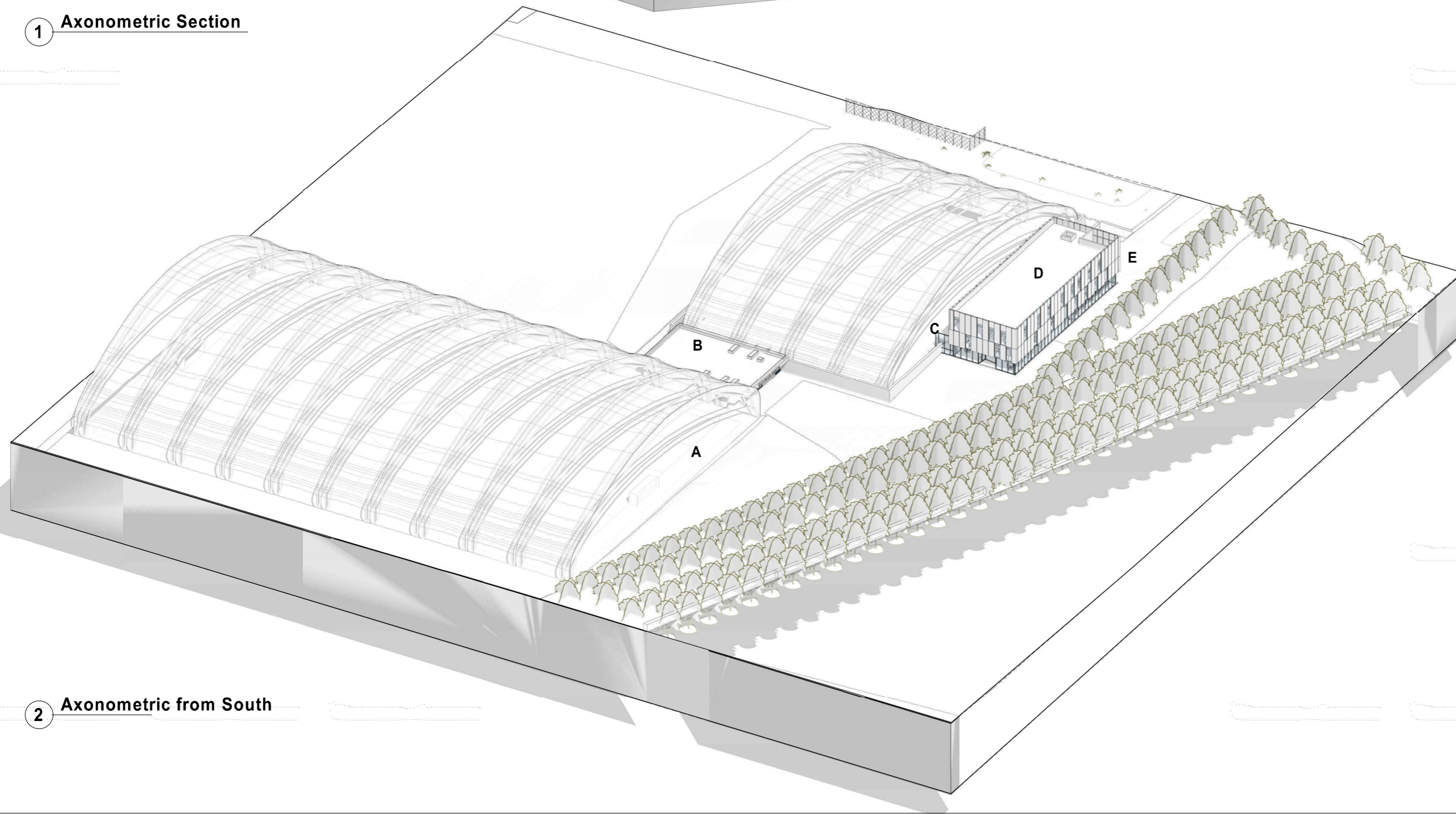

2 Axonometric from South

REVISIONS		
REV	DATE	DESCRIPTION
1	20.10.25	Revision 1

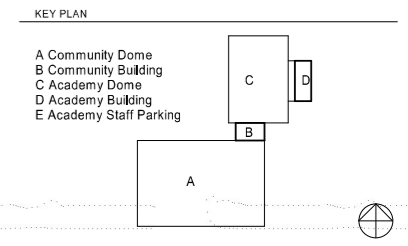

© COPYRIGHT. ALL RIGHTS RESERVED
 THIS WORK IS COPYRIGHTED AND CANNOT BE REPRODUCED OR COPIED IN ANY FORM OR BY ANY OTHER MEANS (GRAPHIC, ELECTRONIC OR MECHANICAL INCLUDING PHOTOCOPIING) WITHOUT THE WRITTEN PERMISSION OF POPULOUS ANY LICENSE, EXPRESS OR IMPLIED, TO USE THIS DOCUMENT FOR ANY PURPOSE WHATSOEVER IS RESTRICTED TO THE TERMS OF THE AGREEMENT OR IMPLIED AGREEMENT BETWEEN POPULOUS AND THE INSTRUCTING PARTY.
 USE FIGURED DIMENSIONS IN PREFERENCE TO SCALED. CHECK ALL DIMENSIONS ON SITE BEFORE FABRICATION OR SETTING OUT.

ARCHITECT

POPULOUS®

14 BLADES COURT | DEODAR ROAD | LONDON | SW15 2NU | UNITED KINGDOM
 TELEPHONE +44 (0)20 8874 7666 FACSIMILE +44 (0)20 8874 7470
 ALL PRODUCTION & INTELLECTUAL PROPERTY RIGHTS RESERVED © POPULOUS 2009

PROJECT NAME

Southend United FC

DRAWING TITLE

Perspective views
 Academy and Community Building

STATUS	PROJECT No.
PLANNING	3093
DATE	SCALE
17/03/17	SIZE
	A1

DRAWN	CHECKED	APPROVED
BD	MT	MT

PROJECT	ORIGIN	ZONE	LEVEL	TYPE	ROLE	DRAWING	REV
SUA-POP-00-	XX-	DR-	A-	0900	01		